

Shell Lubricants



PROTECTION FOR HARDWORKING AGRICULTURAL EQUIPMENT.

DESIGNED TO MEET CHALLENGES



DESIGNED TO CUT COSTS

In agriculture, you are constantly striving to drive down costs and increase your competitiveness. Whether you want to extend the lives of machinery or improve productivity, Shell has lubricants that can help to make a real difference to your bottom line.

These products can help to reduce your equipment ownership costs by providing:

- enhanced protection and reliability
- extended oil and equipment life
- improved energy efficiency

DELIVERING VALUE

Using the right lubricants can substantially reduce costs by:

- cutting unplanned downtime
- lowering maintenance costs
- increasing equipment life and availability.

FULL PRODUCT PORTFOLIO

Shell offers a comprehensive product range that is designed to help you easily select the right lubricants for your needs. This includes petrol and diesel engine oils, gear, axle and transmission fluids, coolants, hydraulic oils, motorcycle, marine and aviation fluids, plus a range of greases.

For further information or to find the right product for your application, contact the **Viva Energy Technical Helpdesk** on **1300 134 205**.

TRANSMISSION, GEAR AND AXLE OILS

Shell Spirax S6 AXME 80W-140 & 75W-90

Shell Spirax S6 AXME is Shell's unique, fuel-efficient, long-life axle oil, and is designed to provide excellent protection for the latest heavy-duty axles and manual transmissions where axle oil is specified. It is specifically formulated with synthetic base oils and additive technology for improved drive-train lubrication and lower operating temperatures. Shell Spirax S6 AXME also helps to promote longer life for equipment operating under highly stressful conditions.

Shell Spirax S6 GME 50

Shell Spirax S6 GME 50 is formulated from synthetic base stocks and additives, which provide excellent flow properties at cold temperatures as well as lubricity and film strength at elevated temperatures. It is a synthetic heavy-duty transmission fluid specially formulated for extended drain and severe service applications.

Shell Spirax S4 CX 10W, 30, 50 & 60

Shell Spirax S4 CX is designed to provide operators with maximum reliability. Shell Spirax S4 CX meets the demanding requirements of modern transmission, final drive, oil immersed brake and hydraulic systems fitted to heavy-duty equipment. Highly consistent and reliable friction performance when used with the advanced metallic and non-metallic materials found in modern systems. Minimal clutch slippage, smooth and quiet brake operation, and reliable transmission operation.



Shell Spirax S4 TXM

Spirax S4 TXM is a premium "universal tractor transmission oil" (UTTO) designed for use in transmissions, hydraulic systems, oil immersed brakes and other ancillary systems fitted to agricultural tractors and off-road equipment. Recognised by leading agricultural equipment manufacturers and suitable for use in most modern equipment, Shell Spirax S4 TXM is ideally suited for transmissions and hydraulic systems of tractors and ancillary equipment. Shell Spirax S4 TXM is formulated using specially selected additives and high quality base oils to provide good low temperature fluidity and wear protection.

Shell Spirax S3 AX 80W-90 & 85W-140

Shell Spirax S3 AX is a high performance axle oil for moderately to heavily loaded on-and off-road drivelines. It has reduced friction for improved efficiency, and is an oil that you can rely on to help protect manual transmissions and axles from pitting, bearing failure and corrosion, providing reduced maintenance and longer equipment life. Shell Spirax S3 AX has excellent oxidation stability for long oil life and contains additives that ensure long-term protection for your components.

Shell Spirax S3 T 15W-40

Shell Spirax S3 T Oil is designed for use in a wide variety of modern agricultural equipment. Using a blend of high viscosity index base oils and an advanced additive package, it is designed to give reliable performance in a wide range of farming applications. Practical, convenient and multifunctional, offering one oil for many lubricant applications around the farm. The high performance capabilities of Shell Spirax S3 T can help maintain the life of most mechanical components helping to prevent early wear of all working parts.

Shell Spirax S2 A 85W-140 & 80W-90

Shell Spirax S2 A is a dedicated, high-quality axle oil. It is an oil that you can rely on to help protect heavily loaded differentials and gear sets high loads and extreme conditions. Shell Spirax S2 has good oxidation stability for long oil life and offers good wear and corrosion protection for longer component life.



DIESEL ENGINE OILS

Shell Rimula R6 MS

Shell Rimula R6 MS fully synthetic oils deliver highly responsive protection, maintenance saving long drain performance, protection against soot, wear, deposits and fuel economy.

Shell Rimula R6 LM

Shell Rimula R6 LM is a fully synthetic oil that features Shells exclusive "Low-SAPS" additive technology and a unique anti-wear system. Protective power is enhanced with synthetic base oil technology, resulting in long engine and oil life.

Shell Rimula R5 LE

Shell Rimula R5 LE oils features "Low-SAPS" additive technology while delivering energy savings. Protective power is enhanced through the use of synthetic base oil technology to deliver fuel economy.

Shell Rimula R4 L

Shell Rimula R4 L oils use "Low-SAPS" additive technology to protect low emission engines under severe conditions. It delivers improvements in wear and deposit control, and resistance to breakdown under high temperatures, loads and tough conditions.

Shell Rimula R4 X

Shell Rimula R4 X is designed to provide Triple Protection to improve engine and oil durability. It helps to lower maintenance costs and increase reliability of vehicles. It's suitable for many heavy-duty diesel engines for on and off highway applications.

Shell Rimula R3+ 30 & Shell Rimula R3+ 40

Shell Rimula R3+ oils adapt to your driving needs to provide extra protection and keep pistons and other engine parts clean. They provide protection against wear for long engine life and protection.

COOLANTS

HD Premium N Antifreeze / Coolant Pre-Diluted 50/50 Concentrate

HD Premium N Antifreeze/Coolant Pre-Diluted 50/50 is a premium fully formulated OAT-Hybrid, nitrated, heavy-duty ethylene glycol engine coolant that is ready to use. Suitable for heavy duty petrol and diesel engines operating in on-road and off-road applications including mining, farming and construction equipment. Specially formulated to help protect cylinder liners from pitting in heavy duty applications, for up to six years, 12,000 hours or 1,000,000 kilometres (whichever comes first).

HYDRAULIC OILS

Shell Tellus S2 MX

Shell Tellus S2 MX fluids are high performance hydraulic fluids based on Group II base oils that provide outstanding protection and performance in most manufacturing and many mobile equipment operations. They resist breakdown under heat or mechanical stress and help prevent damaging deposit formation that can decrease the efficiency of your hydraulic power system.

Shell Tellus S2 VX

Shell Tellus S2 VX fluids are high performance hydraulic fluids based on Group II base oils that provide outstanding protection and performance across a wide range of temperatures. They resist breakdown under heat or mechanical stress and are ideally suited to most mobile equipment and other applications subjected to a wider range of ambient or operating temperatures.



GREASES

Shell Gadus S2 V220 AC 2

Shell Gadus S2 V220 AC greases are high quality multi-purpose greases based on high viscosity index mineral oil and a mixed lithium/calcium soap thickener. They contain extreme pressure, anti-wear, anti-oxidation and anti-corrosion additives to enhance their performance in a wide range of applications.

Shell Gadus S2 V220 AD 2

Shell Gadus S2 V220 AD is an extreme pressure multipurpose grease that contains solids for good shock-load resistance in wet environments. It is a grease you can rely on to provide good wear protection and bearing life when bearings are operating at moderate temperatures. It is widely recognised and listed by leading Original Equipment Manufacturers.

DETERGENTS

Dobatex Gold

Dobatex Gold is a water based, multi-purpose cleaning detergent suitable for a wide range of industrial and automotive applications including the heavier duty demands of mining equipment and fishing and trucking fleets through to routine janitorial cleaning.

Dobatex Gold is highly adaptable to a wide range of cleaning requirements. One flexible product enables you to cut down on inventory, and with varying dilutions and application methods.

WHERE SHELL LUBRICANTS CAN ADD VALUE TO YOUR TRACTOR

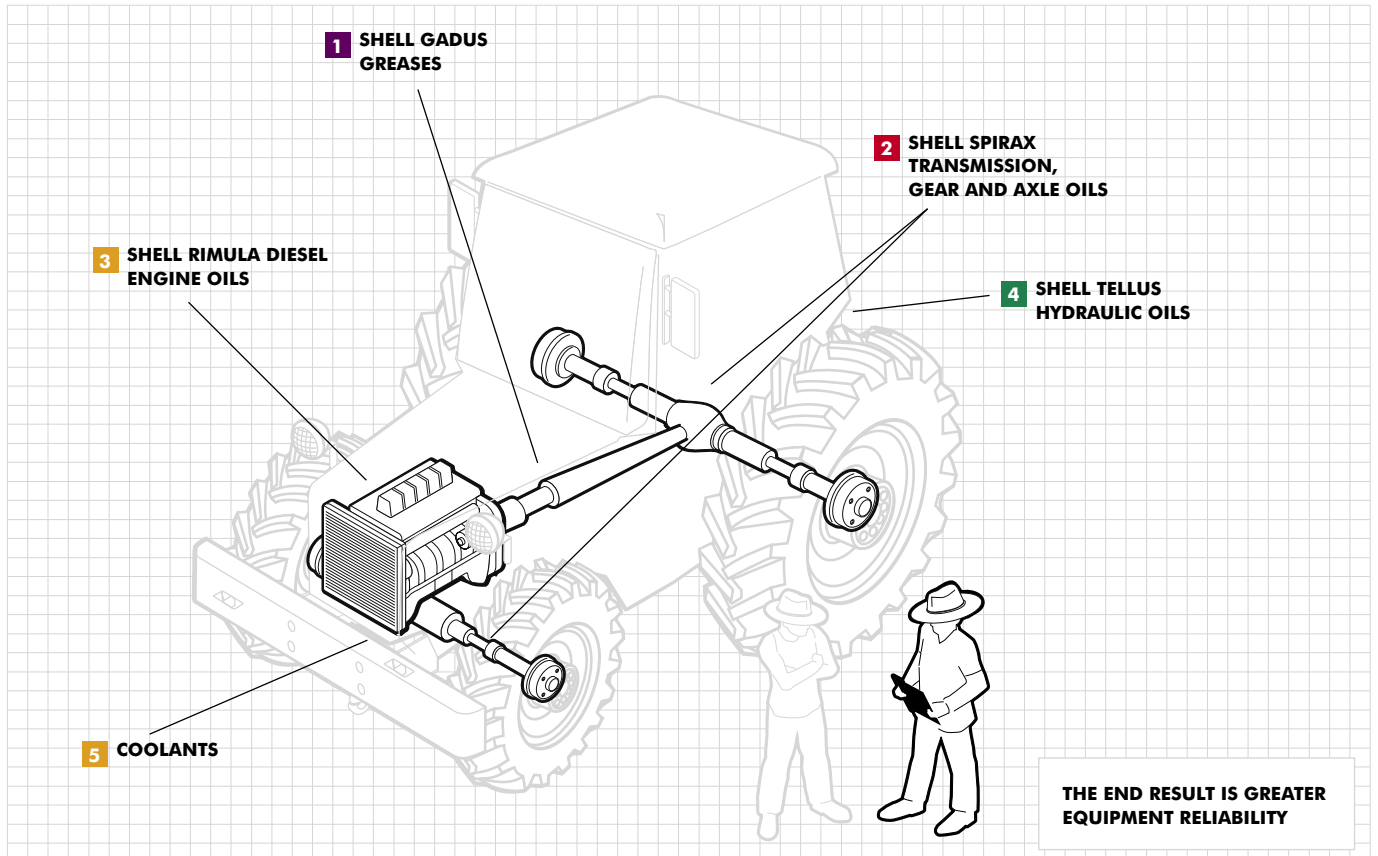

WHERE SHELL LUBRICANTS CAN ADD VALUE TO YOUR TRUCK

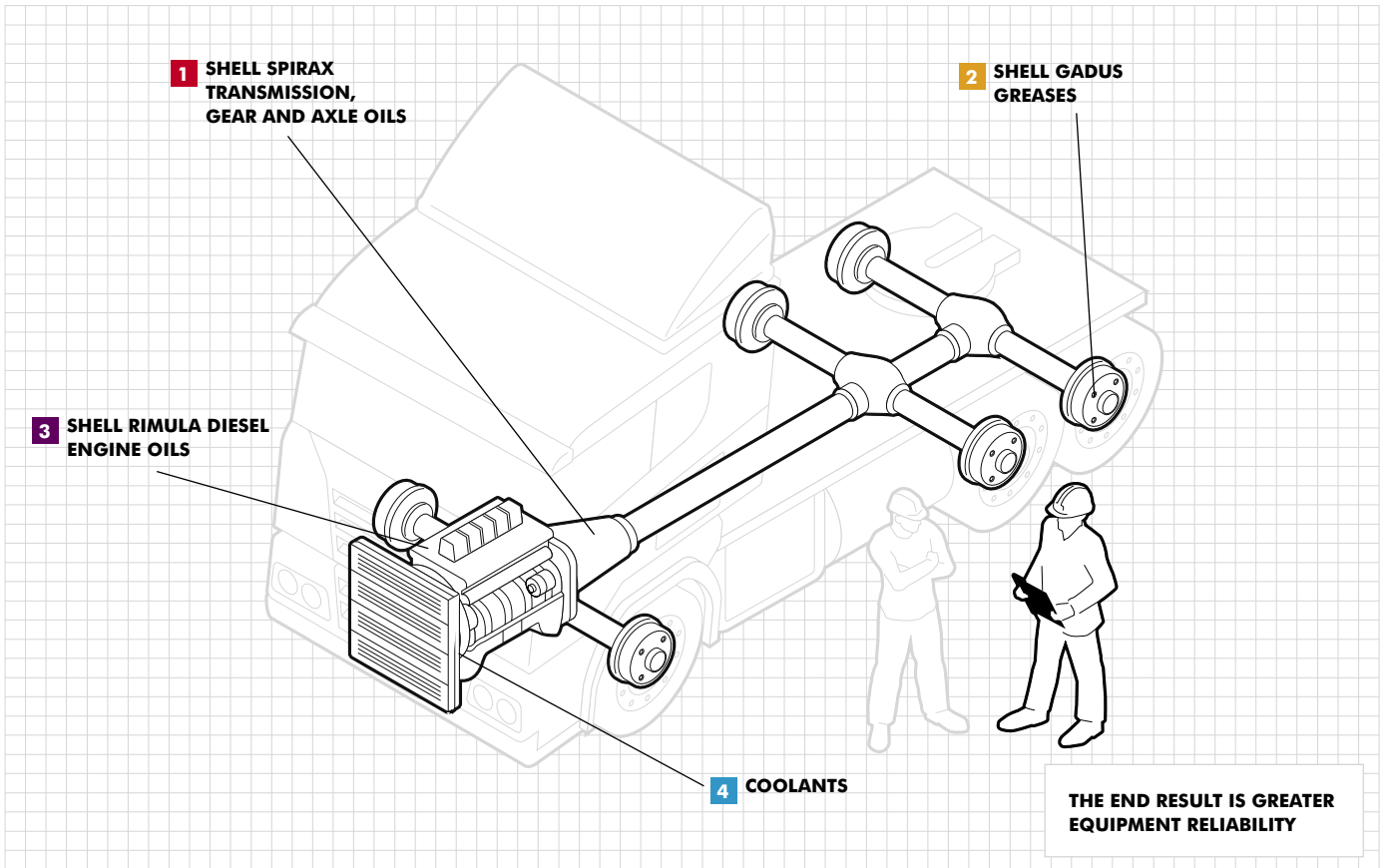

TECHNOLOGY THAT WORKS FOR YOU

In the agricultural industry, machines with operational reliability are critical to a good season. That's why you can't afford equipment downtime from poor lubricants or lubrication practices. Shell Lubricants can help reduce your process and equipment-ownership costs using top-tier oils designed to provide enhanced protection, reduced lubricant consumption and improved efficiency.

All this, thanks to what we call Dynamic Protection Plus Technology – a combination of our unique Shell PurePlus Technology and our Adaptive Additive Technology. The result is a range of top-tier engine oils that actively works to provide benefit in 4 key areas:

- Reducing maintenance costs
- Controlling emissions
- Long oil-drain intervals
- Reducing waste oil

Shell
PUREPLUS
TECHNOLOGY



ADAPTIVE
ADDITIVE
TECHNOLOGY



**DYNAMIC
PROTECTION
PLUS**

ENHANCED EFFICIENCY: Rising fuel costs are a major concern for many customers. One fleet operator reported combined 2%* reductions in fuel consumption by switching to premium Shell Rimula engine oils and Shell Spirax gear and axle oils.

EXTENDED OIL LIFE: Minimising maintenance downtime is a common goal in Agriculture. Many of our customers benefit from keeping their equipment running efficiently for longer by using our high-quality synthetic lubricants and services.

*Actual fuel savings may vary, depending on the application, the current oil used, the maintenance procedures and the condition of the vehicle.



WHO WE WORK WITH

We know you need a reliable agricultural fleet. That's why we work closely with industry OEMs to truly understand your challenges. We believe in investing significantly in research and development to create innovative products that help make savings, and ensure your machinery operates efficiently.

Shell Lubricants are approved by or meet the specifications of over 3,000 Original Equipment Manufacturers (OEM's), including:

- Case New Holland
- Caterpillar
- Clark
- Deutz Fahr
- John Deere
- Kioti
- Komatsu
- Massey-Ferguson
- SAME
- Versatile
- Volvo
- ZF

Shell supports the development of new industry performance specifications by working with international organisations such as:

- Association des Constructeurs Européens d'Automobiles (ACEA)
- American Petroleum Institute (API)
- Japanese Automotive Standards Organization (JASO)

EXTRA SERVICES TO HELP KEEP YOUR EQUIPMENT MOVING

LubeMatch

A free web tool for instant lubricant recommendations for a wide variety of vehicles: www.shell.com.au/lubematch

LubeAdvisor

Offers technical advice to help you choose the right product for your equipment and business needs.

Shell LubeAnalyst

Oil and equipment condition monitoring can give you an early indication of potential issues, to reduce the risk of breakdowns, maintenance and repair costs.

Viva Energy Technical Helpdesk

Viva Energy's Technical Helpdesk is a free service for anyone seeking technical assistance with Shell Lubricants.

To learn more about these services, visit shell.com.au or vivaenergy.com.au today. To start using a service as part of your business, speak to your Shell Lubricants Key Account Manager or call the Viva Energy Technical Helpdesk on 1300 134 205.



Viva Energy Australia Pty Ltd
ABN 46 004 610 459



Shell Lubricants
Macro Distributor

Customer Solutions 13 16 18
Technical Helpdesk 1300 134 205

"Shell Lubricants" refers to the various Shell companies engaged in the lubricants business.
* Actual fuel savings may vary, depending on the application, the current oil used, the maintenance procedures and the condition of the vehicle.
** Compared to standard mineral oil based products. Magnitude of benefits depends on individual products.

Content correct as at May 2017